

Adaptive flange FFA PN 10/PN 16

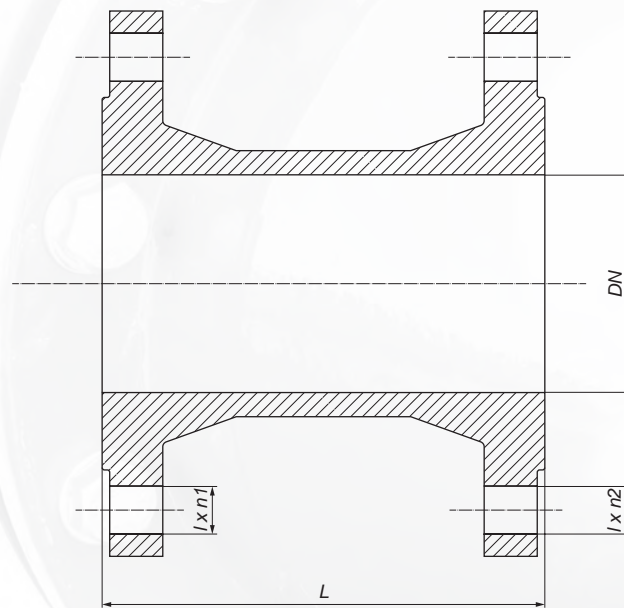

It is used to install supply fittings in a situation of incompatible number of holes on the connected flanges.

Coating: bitumen paint,
poliester paint min. 250 μm

* Material: cast iron EN-GJL-250, PN-EN 1561:2012

** Material: ductile iron EN-GJS-500-7, PN-EN 1563:2018

Nominal pressure: 1,0/1,6 MPa; PN 10/16

DN	L	Number of holes	$l \times n1$	$l \times n2$	Weight
80*	100	4/8	18 x 4	18 x 8	8,20
100*	200	4/8	18 x 4	18 x 8	13,00
200**	200	8/12	22 x 8	22 x 12	25,00