

Spigot FW PN 10 and ductile iron PN 10/16

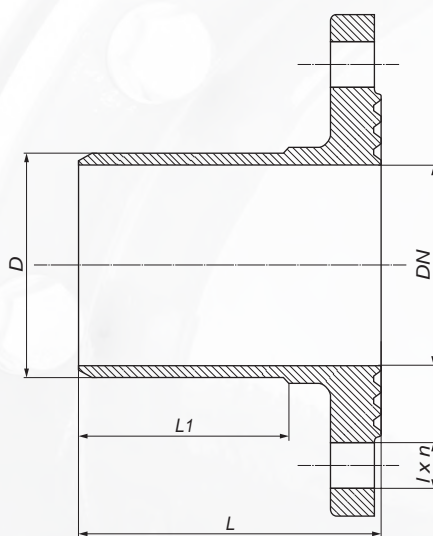

It is used to connect the socket end of the PVC pipe with supply flange.

Coating: bitumen paint,
poliester paint min. 250 μm
Material: cast iron EN-GJL-250, PN-EN 1561:2012
Flange connection: PN-EN 1092-2:1999
Nominal pressure: 1,0 MPa; PN 10

Coating: poliester paint min. 250 μm
Material: ductile iron EN-GJS-500-7, PN-EN 1563:2018
Flange connection: PN-EN 1092-2:1999
Nominal pressure: 1,0/1,6 MPa; PN 10/16

DN	D	L1	L	l	n	Weight
50	63	70	95	18	4	2,60
80	90	85	115	18	4(8)	4,10
100	110	95	120	18	8	4,90
150	160	125	145	22	8	9,40
200	200	135	165	22	8(12)	15,00
200	225	135	165	22	8(12)	16,00
250	250	165	200	22(26)	12	22,00
250	280	165	200	22(26)	12	25,00
300	315	215	250	22(26)	12	31,00
400	400	265	320	26	16	46,00
500	500	285	340	26	20	89,00

DN	D	L1	L	l	n	Weight
50	63	94	120	18	4	3,70
80	90	103	131	18	8	5,70
100	110	111	138	18	8	6,90
150	160	128	158	22	8	12,00
200	225	148	178	22	8(12)	20,00
250	250	157	190	22(26)	12	23,00
250	280	177	202	22(26)	12	24,00
300	315	177	214	22(26)	12	30,00